

weber.rend SR

masonry substrate



weber.rend SR is a one coat render system designed and manufactured for the plastering professional to produce a sound background with a smooth or textured synthetic coating

one coat render

MASONRY BACKGROUND

SR326

facade systems

*weber.rend OCR3 is designed for application on to sound medium density masonry suitable to take a designation III mix (1:1:6) - this should be confirmed by block manufacturer. The nature and condition of the background is a prime consideration in deciding the preparatory treatment prior to the application of weber.rend OCR. Guidance in respect to movement joints and bed joint reinforcement should be obtained from block manufacturer and **MUST** be adhered to. The recommendations detailed in BS5628 : Part 3 and BS5262 should be observed*

suitable substrate or background prepared for rendering

weber.rend aid keying coat if required to give key or control suction

weber.rend OCR - one coat render (OCR 3) applied 15mm (nom.) thick and finished smooth

finish shown - **weber.plast P** (2 Coats)
other suitable finishes - weber.plast DF
weber.plast TF
weber.sil TF
weber.sil P

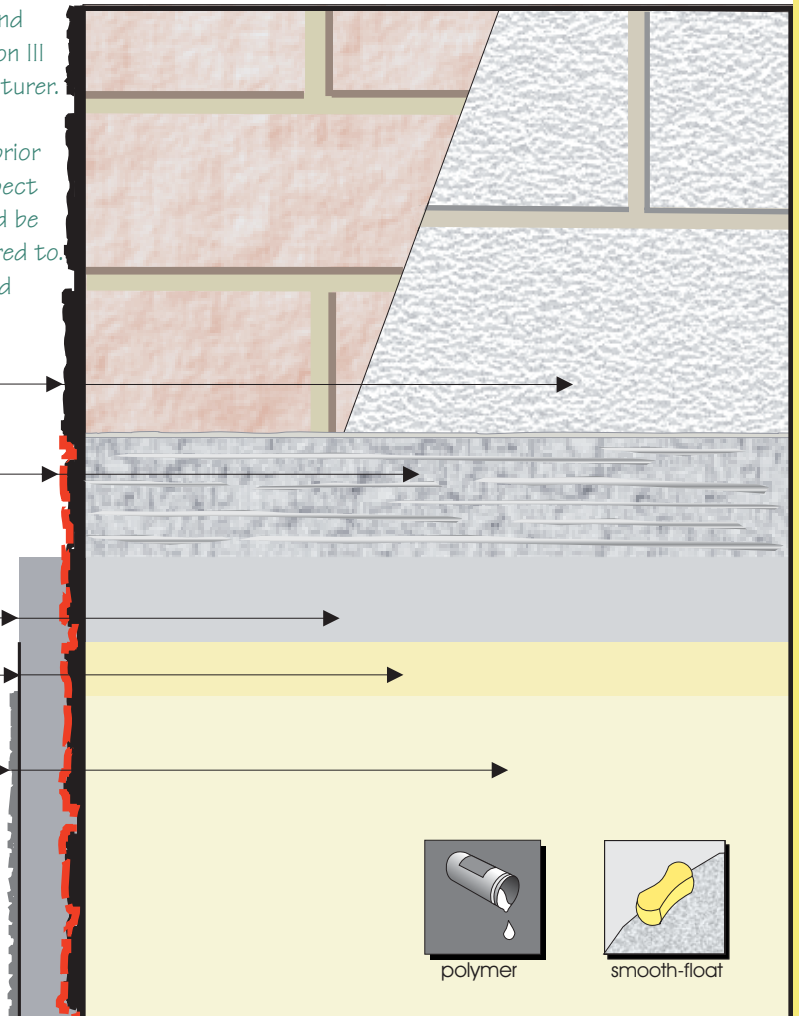

SYSTEM SECTION | SYSTEM VIEW



Price Guide for system applied

Issue date

FOR THE DESIGNER....

weber.rend SR is a one-coat render system comprising a 15mm coat of **weber.rend OCR 3**, applied in one operation and floated smooth to provide a background for the finish. The floated render coat is finished using 2 coats of **weber.plast P** smooth textured synthetic coating available in a choice of bright colours.

FOR THE ESTIMATOR....

Materials in the **weber.rend SR** system and coverages -

weber.rend aid (if specified) 3mm	- 4 kg/m ² in 25kg bags
weber.rend OCR 3 (render coat) 15mm	- 27 kg/m ² in 25kg bags
weber.plast P	- 0.27 litre/m ² in 10 litre tubs
+ beads and trims as specified	
other products (if specified)	
weber CL150	- 0.1 litre/m ² in 5 litre bottles or 25 litre drums
weber.rend aid key coat (2 - 3mm)	- 4 kg/m ² in 25kg bags
weber.mesh standard	- 50x1m roll (100mm lap)

This system is one of a range of comprehensive facade solutions covering external wall insulation, renders and concrete repair manufactured in the UK by **Weber**



FOR THE SPECIFIER an outline specification in NBS format

PROJECT:

SPECIFICATION CLAUSES.

M20 PLASTERED/RENDERED/ROUGHCAST COATINGS.

To be read with Preliminaries/General conditions.

TYPE [S] OF COATINGS.

160 WEBER PROPRIETARY ONE-COAT RENDER SYSTEM:

weber.rend SR – masonry background

weber.plast P smooth textured finish

- **Location:** To specified wall areas as identified on Architect's drawings or other Contract Documents.
- **Background:** New sound Brick / Block or existing un-rendered & unpainted sound masonry. Substrate must be of appropriate strength and durability with suitable key and suction. For new blockwork guidance in respect to movement joints and bed joint reinforcement should be obtained from block manufacturer and MUST be adhered to. The recommendations detailed in BS5628 : Part 3 and BS5262 should be observed.
- **Preparation:** For existing substrates, or where required on new substrates, drench apply **weber CL150** wash and leave for 48 hours. Brush down to remove all moss / growth. Make good defective areas using **weber.rend aid** and **weber.rend OCR** to achieve an in-plane surface. If no mechanical key present or suction control required, apply a **weber.rend aid** key coat, fully scratched back to the masonry substrate.
- **Render Coat: weber.rend OCR**
weber.rend OCR 3 factory batched one-coat mortar shall be uncoloured and un-modified, comprising appropriate quantities of FS1 sand, lime and cement.
Thickness: 15mm (applied as one coat in one or two passes).
- **Finish: weber.plast P** (Silicone-enhanced acrylic based protective coating).
weber.plast P smooth textured finish, in selected colour, factory batched, wet mix supplied in 10 litre plastic buckets, brush or roller applied in 2 coats.
- **Accessories:** Render only beads, if required by the system or product, or if specified, shall be of appropriate design, gauge and material as approved by **Weber**. Beads to be located and fixed as detailed on Architect's drawings or System Manufacturer's details (this may involve bedding RO beads in mortar).
Where meshcloth is being incorporated as treatment to areas of potential high stress it shall be **weber.mesh** standard a standard duty, balanced, open weave, glass fibre meshcloth, coated for alkaline resistance, available in 1m x 50m rolls.

FOR THE APPLICATOR an application overview

- **Suitable Substrates:** New or Existing sound brickwork, blockwork or concrete suitable to take a designation III (1:1:6) mix. Substrate must provide suitable key / suction and incorporate movement joints and / or bed joint reinforcement as required by the brick / block manufacturer. The recommendations detailed in BS5628 : Part 3 and BS5262 should be observed.
- **Surface Preparation:** Dependant on type of substrate this could involve one or more of the following: -
 - **weber CL150** fungicidal wash to kill moss, algae or unseen spores
 - **weber.rend aid** to control suction or as a key coat to provide mechanical key

For existing substrates, or where required on new substrates, drench apply **weber CL150** wash and leave for 48 hours. Brush down to remove all moss / growth. Make good defective areas (on existing) using **weber.rend aid** and **weber.rend OCR** to achieve an in-plane surface.
Fit render only base (drip), stop and corner beads, where required, with fixings as approved by **Weber**.
If no mechanical key exists, or if suction control is required, apply a 3mm rend-aid key coat, and after partial take-up, thoroughly comb scratch horizontally, back to the existing brick / block. Allow to dry.
- **Weber** recommend incorporating **weber.mesh** standard (meshcloth) into the first 5mm of render, or into the **weber.rend aid** key coat if being used, to areas of typical stress points in the construction, such as above and below openings, to reduce the risk of substrate cracking reflecting through the render.
- **Render Coat:** Mix and apply **weber.rend OCR** to 15mm (nominal) thickness. Rule off with a straight edge to achieve satisfactory in-plane surface. Remove all trowel marks and allow to dry.
- **Finishing Coat:** Apply **weber.plast P** by brush or roller, in 2 coats, all in accordance with manufacturer's printed instructions.

General: Pre-bagged mortar must be stored completely dry and used in strict rotation of delivery. Stack tubs of wet mixed products no more than 2 high. Do not apply any formless wet materials in temperatures below 5°C. Do not work in high temperatures when flash setting of materials may occur. Provide adequate protection from frost, high winds and precipitation during application and curing. Apply all materials in accordance with full, detailed printed instructions.

Refer to current Product Data Sheets for further information.

FOR FURTHER INFORMATION contact

weber_rend SR326 (b)

Regional / Area
Sales Manager

Telephone
Number

Weber

GB / HEAD OFFICE: Dickens House, Enterprise Way, FLITWICK, Bedford MK45 5BY

Tel: +44(0)1525 718 877 Fax: +44(0)1525 718 988

IRELAND: Old Paper Mill, BALLYCLARE, Co Antrim BT39 9EB

Tel: +44(0)28 9334 3700 Fax: +44(0)28 9332 3232

This document is the copyright of **Weber** and must not be copied in part or in whole without permission