

weber.rend PR

masonry substrate



weber.rend PR [PR401] is a two coat render system designed and manufactured for the plastering professional to produce a sound background with a dry dash finish

two coat render

MASONRY BACKGROUND

PR401

facade systems

- suitable masonry substrate or background prepared for rendering
- raked joints for key
alternative - apply **weber.rend stipple**
polymer modified stipple coat
- weber.rend PUC** undercoat
- 10mm thick
- weber.rend TTC** top coat
6-8mm
- dry dash finish

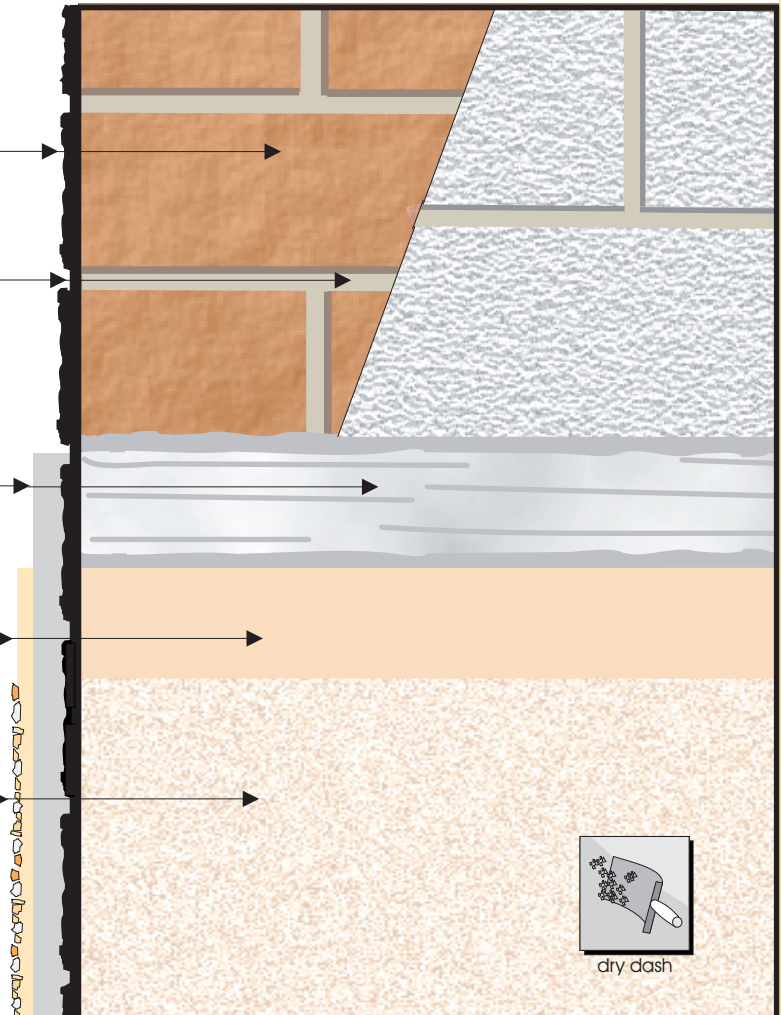

SYSTEM SECTION | SYSTEM VIEW



Price Guide
for system
applied

Issue
date

FOR THE DESIGNER....

weber.rend PR [PR401] is a two coat render system comprising a 10mm **weber.rend PUC** undercoat followed by a 6-8mm **weber.rend TTC** coloured top coat with a dry dash finish.

FOR THE ESTIMATOR....

Materials in the **weber.rend PR [PR401]** system and coverages:

weber.rend PUC (10mm)	- 18kg/m ² in 25kg bags
weber.rend TTC (6mm finished)	- 10kg/m ² in 25kg bags
weber dry dashing aggregate	- 10kg/m ²
+ beads and trims as specified	
other products (if specified)	
weber.rend stipple (3mm)	- 5kg/m ² in 25kg bags

This system is one of a range of comprehensive facade solutions covering external wall insulation, renders and concrete repair manufactured in the UK by **Weber**



FOR THE SPECIFIER an outline specification in NBS format

PROJECT:

SPECIFICATION CLAUSES.

M20 PLASTERED/RENDERED/ROUGHCAST COATINGS.

To be read with Preliminaries/General conditions.

TYPE [S] OF COATINGS.

160 WEBER PROPRIETARY RENDER SYSTEM:

weber.rend PR [PR401] – masonry background

weber dry dash finish

- **Location:** To specified wall areas as identified on Architect's drawings or other Contract Documents.
- **Background:** New sound Brick / Block or existing un-rendered & unpainted sound masonry. Substrate must be of appropriate strength and durability with suitable key and suction. For new blockwork guidance in respect to movement joints and bed joint reinforcement should be obtained from block manufacturer and **MUST** be adhered to. The recommendations detailed in BS5628 : Part 3 and BS5262 should be observed.
- **Preparation:** For existing substrates, or where required on new substrates, drench apply **weber CL150** wash and leave for 48 hours. Brush down to remove all moss / growth. Make good defective areas using **weber.rend stipple** and **weber.rend PUC** to achieve an in-plane surface. If no mechanical key present or suction control required, apply a **weber.rend stipple** key coat, fully scratched back to the masonry substrate.
- **Undercoat: weber.rend PUC**
weber.rend PUC factory batched mortar for undercoating shall be uncoloured and polymer modified, comprising appropriate quantities of FS1 sand, powdered waterproofer, cement and dry polymer.
Thickness: 10mm
- **Top Coat: weber.rend TTC**
weber.rend TTC factory batched mortar for dry dashing or smooth floating to take synthetic finishes, coloured and unmodified, comprising appropriate quantities of FS1 sand, lime, powdered waterproofer, cement and pigment.
Thickness: 6-8mm
- **Finish:** selected **dry dash aggregate**
- **Accessories:** Render only beads, if required by the system or product, or if specified, shall be of appropriate design, gauge and material as approved by **Weber**. Beads to be located and fixed as detailed on Architect's drawings or System Manufacturer's details (this may involve bedding RO beads in mortar).

FOR THE APPLICATOR an application overview

- **Suitable Substrates:** New sound brickwork or blockwork or existing un-rendered & un-painted sound masonry with adequate surface key. On new brickwork joints must be thoroughly raked for key.
- **Surface Preparation:** For existing substrates, or where required on new substrates, drench apply **weber CL150** wash and leave for 48 hours. Brush down to remove all moss / growth. Make good defective areas (on existing) using **weber.rend stipple** and **weber.rend PUC** to achieve an in-plane surface.
Fit render only base (drip), movement and stop beads, where required, with fixings as approved by **Weber**.
- **Undercoat:** Mix and apply **weber.rend PUC** to 10mm (nominal) thickness. Rule off with a straight edge to achieve satisfactory in-plane surface. Remove all trowel marks and after partial take-up, thoroughly comb scratch horizontally, for key. Allow to dry.
- **Top Coat:** Mix and apply **weber.rend TTC** to 6-8mm thickness (as appropriate for grade of dashing aggregate) and float up to produce a satisfactory in-plane surface. Remove all trowel marks and high spots in coat and cast in pre-dampened natural aggregate, as selected, to give even texture and distribution.

General: Pre-bagged mortar must be stored completely dry and used in strict rotation of delivery. Stack tubs of wet mixed products no more than 2 high. Do not apply any formless wet materials in temperatures below 5°C. Do not work in high temperatures when flash setting of materials may occur. Provide adequate protection from frost, high winds and precipitation during application and curing. Apply all materials in accordance with full, detailed printed instructions.

Refer to current Product Data Sheets for further information.

FOR FURTHER INFORMATION contact

weber_rend PR401 (a)

Regional / Area
Sales Manager

Telephone
Number

Weber

GB / HEAD OFFICE: Dickens House, Enterprise Way, FLITWICK, Bedford MK45 5BY
IRELAND: Old Paper Mill, BALLYCLARE, Co Antrim BT39 9EB

Tel: +44(0)1525 718 877 Fax: +44(0)1525 718 988
Tel: +44(0)28 9334 3700 Fax: +44(0)28 9332 3232

This document is the copyright of **Weber** and must not be copied in part or in whole without permission