

weber.rend MT

panel substrate



weber.rend MT is a render system suitable for application to sheathing clad steel or timber framed walls or soffits, meshcloth rendered and finished with a textured synthetic finish

meshtex

PANEL BACKGROUND
MT112 P

facade systems

metal or timber framing of sufficient strength and stiffness to support the sheathing without deflection

fibre reinforced medium density calcium silicate panel

1st **weber.rend LAC** coat

weber mesh standard (glassfibre meshcloth)

2nd **weber.rend LAC** coat

weber PR310 primer (tinted)

finish shown - **weber.plast DF**
other suitable finishes - **weber.plast TF**
weber.sil TF
plastene SG
weber.plast P

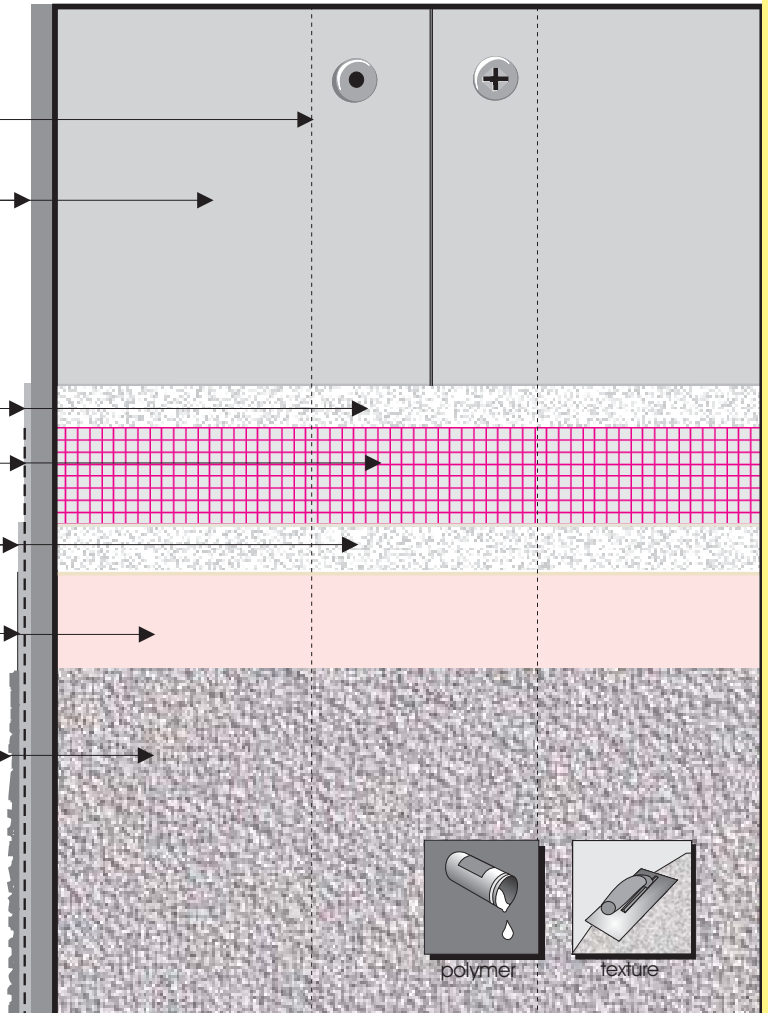

SYSTEM SECTION | SYSTEM VIEW



Price Guide
for system
applied

Issue
date

FOR THE DESIGNER....

weber.rend MT (panel) is designed to produce a rendered texture finish on a panelled background supported by conventional framing, where large areas can be clad without expressed joints.

The surface of the calcium silicate panels is protected with a 6mm meshcloth reinforced coat of **weber.rend LAC**, which gives good impact resistance and weather protection, and a coat of **weber.plast DF** textured finish.

FOR THE ESTIMATOR....

Materials in the **weber.rend MT** (panel base) system and coverages - calcium silicate cladding panels (10mm) 2440x1220mm

weber.rend LAC (6mm) - 6.5kg/m² in 20kg bags

weber mesh standard - 50x1m roll (100mm lap) - approx. 45m² / roll

weber PR310 primer - 0.25litre/m² in 10 litre tubs

weber.plast DF 100 - (1 mm texture) - 1.5kg/m² in 15kg tubs

or **weber.plast DF 300** - (3.0mm texture) - 3.8kg/m² in 15kg tubs

+ beads and trims as specified

This system is one of a range of comprehensive facade solutions covering external wall insulation, renders and concrete repair manufactured in the UK by **weber building solutions**



FOR THE SPECIFIER an outline specification in NBS format

PROJECT:

SPECIFICATION CLAUSES.

M20 PLASTERED/RENDERED/ROUGHCAST COATINGS.

To be read with Preliminaries/General conditions.

TYPE [S] OF COATINGS.

160 weber PROPRIETARY REINFORCED RENDER SYSTEM:

weber.rend MT - panel background

weber.plast TF finish

- **Location:** To specified wall areas as identified on Architect's drawings or other Contract Documents.
- **Background:** Timber or metal frame structure with BluClad (calcium silicate) panels in-plane of adequate thickness, to provide appropriate support and stiffness for **weber.rend MT** reinforced render system without deflection or edge protrusions.
- **Reinforcing coat: weber.rend LAC**
Adhesive mortar for scrimming shall be uncoloured and polymer modified, comprising appropriate quantities of FS2 sand, lime, cement, lightweight fillers and dry polymer.
Thickness: 6mm (applied in two coats incorporating mesh cloth).
- **Reinforcement: weber** mesh standard
Meshcloth shall be standard duty, balanced, open weave, glassfibre meshcloth, coated for alkaline resistance, in 1m x 50m roll.
- **Finish: weber PR310** primer and **weber.plast DF**
Primer for colour washing, prior to application of **weber.plast DF**, to be **weber PR310** tinted primer, low viscosity liquid, brush, spray, or roller applied. **weber.plast DF** finish, in selected colour, factory batched, wet mix supplied in 15kg tubs, trowel applied and textured using a wood or thin plastic float.
- **Accessories:** Render only beads, if required by the system or product, or if specified, shall be of appropriate design, gauge and material as approved and supplied by **weber building solutions**. Beads to be located and fixed as detailed on Architect's drawings or System Manufacturer's details.
Structural, temporary or bead fixings shall be of suitable strength and durability approved and supplied by **weber building solutions**.

FOR THE APPLICATOR an application overview

- **Suitable Substrates:** BluClad (or other sheathing approved by **weber**) secured to supporting framing using suitable fixings to produce a rigid in-plane surface without surface deflection.
- **Surface Preparation:** Ensure board edges are free from protrusions and flush. Remove all dust and surface contamination.
- **Reinforcing Coat:** Mix and apply **weber.rend LAC** 3mm thick and incorporate glass fibre meshcloth as specified. Lay-in and allow for partial take-up; apply further 3mm. Remove all trowel marks and dress off surface smooth with a sponge. Allow to dry.
- **Finishing Coat:** Apply **weber PR310** tinted primer by roller, spray or brush. Apply **weber.plast TF** using a stainless steel trowel and work to an acceptable texture using a wood / thin plastic float, all in accordance with manufacturer's printed instructions.

General: Pre-bagged mortar must be stored completely dry and used in strict rotation of delivery. Stack tubs of wet mixed products no more than 2 high. Do not apply any formless wet materials in temperatures below 5°C. Do not work in high temperatures when flash setting of materials may occur. Provide adequate protection from frost, high winds and precipitation during application and curing. Apply all materials in accordance with full, detailed printed instructions.

Refer to current Product Data Sheets for further information.

FOR FURTHER INFORMATION contact

weber_rend MT112Pa

Regional / Area
Sales Manager

Telephone
Number

weber building solutions

GB / HEAD OFFICE: Dickens House, Enterprise Way, FLITWICK, Bedford MK45 5BY

Tel: +44(0)1525 718 877 Fax: +44(0)1525 718 988

IRELAND: Old Paper Mill, BALLYCLARE, Co Antrim BT39 9EB

Tel: +44(0)28 9334 3700 Fax: +44(0)28 9332 3232

This document is the copyright of **weber building solutions** and must not be copied in part or in whole without permission